

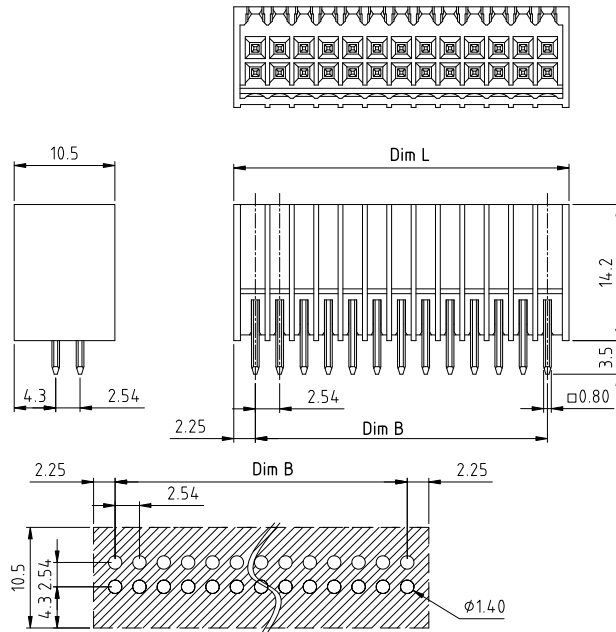

## CAHGBV254-SERIES

Pitch 2,54mm



Critical dimension:  $\nabla$

Dim.L=(1/2P-1)x2.54+4.5

Dim.B=(1/2P-1)x2.54

P=Number of poles (04-48)

	Dim B	Dim L
0-30mm	+/- 0,15	+/- 0,20
over 30-60mm	+/- 0,20	+/- 0,25
over 60-90mm	+/- 0,25	+/- 0,30
over 90mm	+/- 0,30	+/- 0,40

Tolerance	
x.	+/- 0,50
x.x	+/- 0,30
x.xx	+/- 0,10
x°	+/- 1°

Units:mm

### Technical data

Technical data in accordance with UL/CUL

	Use Group	B	C	D
Nominal voltage (V)		150	50	-
Nominal current (A)		5	5	-
Connection capacity (AWG)		-	-	-

Technical data in accordance with IEC

Rated insulation voltage at pollution degree 2 (V)		160	
Rated current/conductor cross-section (A/mm <sup>2</sup> )		6 / -	
Solid/stranded(mm <sup>2</sup> )		-	
Surge voltage category/pollution degree	III / 3	III / 2	II / 2
Rated insulation voltage(V)	32	160	160
Rated surge voltage(kV)	2.5	2.5	2.5

General data

Flange nut thread		-
Flange nut tightening torque(Nm)		-
Insulation Withstanding Voltage		AC 1300 / 1min
Insulation Resistance		1000M $\Omega$ or more at DC500V
Using temperature range		-40°C-120°C
Soldering temperature		250 $\pm$ 10°C/5s

Materials

Insulation material group		Pa66 I UL94 -V0
PIN		Copper, Tin plated
Flange PIN		-
Borehole diameter/pin dimensions(mm)		1.4/0.80*0.80

### Packing information

Poles	Order Number	SPQ
4	CAHGBV25404x000	600
6	CAHGBV25406x000	400
8	CAHGBV25408x000	300
10	CAHGBV25410x000	260
12	CAHGBV25412x000	240
14	CAHGBV25414x000	240
16	CAHGBV25416x000	240
18	CAHGBV25418x000	240
20	CAHGBV25420x000	200
22	CAHGBV25422x000	180
24	CAHGBV25424x000	180
26	CAHGBV25426x000	120
28	CAHGBV25428x000	120
30	CAHGBV25430x000	120
32	CAHGBV25432x000	120
34	CAHGBV25434x000	120
36	CAHGBV25436x000	80
38	CAHGBV25438x000	75
40	CAHGBV25440x000	75
42	CAHGBV25442x000	65
44	CAHGBV25444x000	65
46	CAHGBV25446x000	65
48	CAHGBV25448x000	65

### Ordering code

CAHG BV 254 xx x xxx

① ② ③ ④ ⑤ ⑥

- ① Type
- ② Product style
- ③ Pitch
- ④ Poles (04-48)
- ⑤ Color
- ⑥ Standard 000 or Custom XXX

Color

0 Black	5 Green
1 Brown	6 Blue
2 Red	G Pale grey
3 Orange	8 Dark grey
4 Yellow	9 White

### Key Commercial data

Custom tariff number	8536901000
Country of origin	CN (China)

### Mating with headers

CAPDSD254 Series

