

CAPAST508-SERIES

cAUs E501953

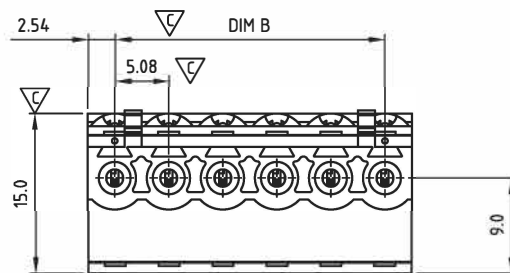
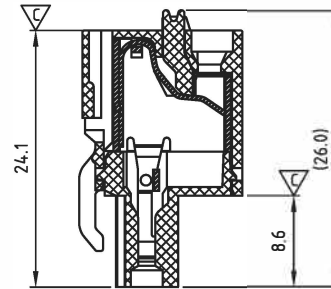
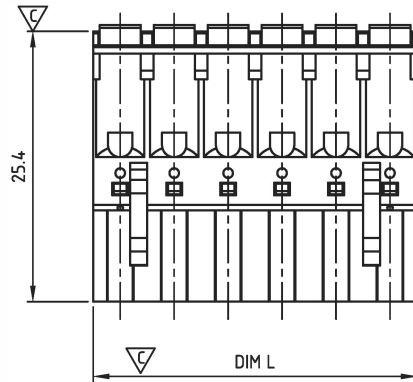

2P Hook

Critical dimension: ∇

Dim.L=Px5.08

Dim.B=(P-1)x5.08

P=Number of poles (02-24)

	Dim B	Dim L
0-30mm	+/- 0,15	+/- 0,20
over 30-60mm	+/- 0,20	+/- 0,25
over 60-90mm	+/- 0,25	+/- 0,30
over 90mm	+/- 0,30	+/- 0,40

Tolerance	
x	+/- 0,50
x.x	+/- 0,30
x.xx	+/- 0,10
x°	+/-1°
∇	Units:mm

Technical data

Technical data in accordance with UL/CUL

	Use Group	B	C	D
Nominal voltage (V)	300	-	-	300
Nominal current (A)	10	-	-	10
Connection capacity (AWG)	26-12	-	-	26-12

Technical data in accordance with IEC

Rated insulation voltage at pollution degree 2 (V)	320
Rated current/conductor cross-section (A/mm ²)	12 / 2.5
Solid/stranded(mm ²)	0.2-2.5 / 0.2-2.5
Surge voltage category/pollution degree	III / 3 III / 2 II / 2
Rated insulation voltage(V)	250 320 630
Rated surge voltage(kV)	4 4 4

General data

Stripping length (mm)	9-10
Flange Screw thread	-
Flange Screw tightening torque(Nm)	-
Insulation Withstanding Voltage	AC1600V / 1min
Insulation Resistance	1000M Ω or more at DC500V
Using temperature range	-40°C-115°C

Materials

Insulation material group	PA 66 UL94 -V0
Wire guard	PhBz, Tin plated
Spring	Stainless steel
Flange Screw	-

Packing information

Poles	Order Number	SPQ
2	CAPAST50802x000	250
3	CAPAST50803x000	160
4	CAPAST50804x000	120
5	CAPAST50805x000	80
6	CAPAST50806x000	80
7	CAPAST50807x000	60
8	CAPAST50808x000	60
9	CAPAST50809x000	50
10	CAPAST50810x000	40
11	CAPAST50811x000	40
12	CAPAST50812x000	40
13	CAPAST50813x000	30
14	CAPAST50814x000	30
15	CAPAST50815x000	25
16	CAPAST50816x000	25
17	CAPAST50817x000	25
18	CAPAST50818x000	25
19	CAPAST50819x000	25
20	CAPAST50820x000	20
21	CAPAST50821x000	20
22	CAPAST50822x000	20
23	CAPAST50823x000	20
24	CAPAST50824x000	20

Ordering code

CAPAST 508 xx x xxx
① ② ③ ④ ⑤ ⑥

- ① Type
- ② Product style
- ③ Pitch
- ④ Poles (02-24)
- ⑤ Color
- ⑥ Standard 000 or Custom XXX

Color

0 Black	5 Green
1 Brown	6 Blue
2 Red	7 Pale grey
3 Orange	8 Dark grey
4 Yellow	9 White

Key Commercial data

Custom tariff number	8536901000
Country of origin	CN (China)

Mating with headers

CAHAAH508 Series

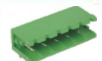

CAHAAV508 Series



CAHABH508 Series

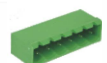

CAHABV508 Series



CAHAEH508 Series

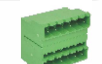

CAHAEV508 Series

