

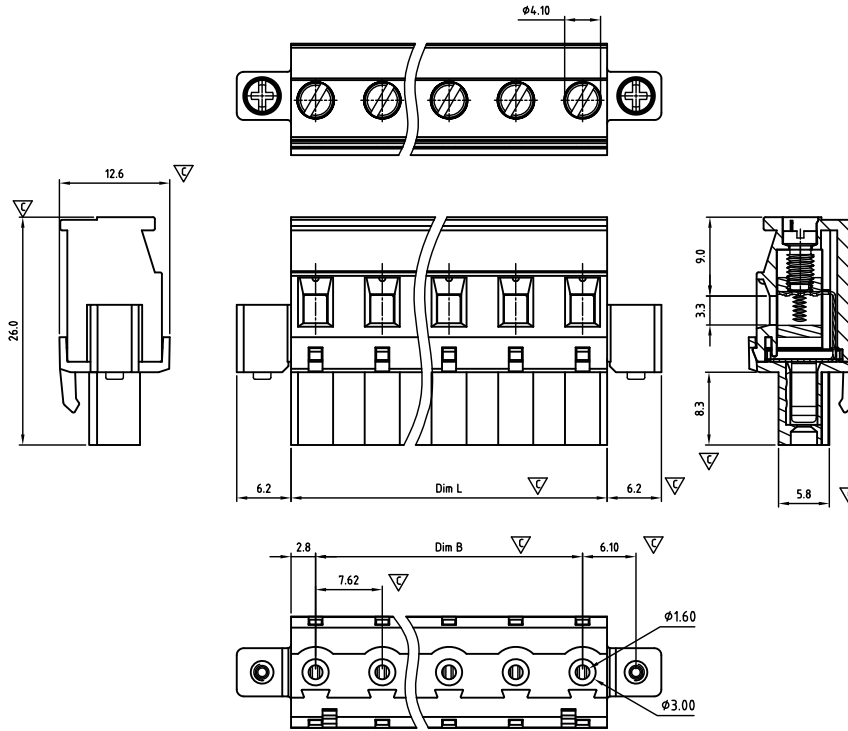

CAMBFW762-SERIES

cULus E501953



Critical dimension: ▽

Dim.L=Px3.5		
Dim.B=(P-1)x3.5		
P=Number of poles (02-24)		
	Dim B	Dim L
0-30mm	+/- 0,15	+/- 0,20
over 30-60mm	+/- 0,20	+/- 0,25
over 60-90mm	+/- 0,25	+/- 0,30
over 90mm	+/- 0,30	+/- 0,40

Tolerance	
x.	+/- 0,50
x.x	+/- 0,30
x.xx	+/- 0,10
x°	+/- 1°
Units:mm	

Technical data

Technical data in accordance with UL/CUL

	Use Group	B	C	D
Nominal voltage (V)		300	-	300
Nominal current (A)		15	-	10
Connection capacity(AWG)		30-12	-	30-12

Technical data in accordance with IEC

Rated insulation voltage at pollution degree 2 (V)		630		
Rated current/conductor cross-section (A/mm ²)		12 / 2.5		
Solid/stranded(mm ²)		0.2-2.5 / 0.2-2.5		
Surge voltage category/pollution degree	III / 3	III / 2	II / 2	
Rated insulation voltage(V)	400	630	1000	
Rated surge voltage(kV)	6	6	6	

General data

Stripping length(mm)		6-7
Screw thread		M3
Tightening torque(Nm)		0.5-0.6
Insulation Withstanding Voltage		AC1600V / 1min
Insulation Resistance		1000MΩ or more at DC500V
Using temperature range		-40°C-115°C

Materials

Insulation material group		PA 66 I UL94 -V0
Wire guard		PhBz, Tin plated
Cage		Brass, Ni plated
Screw		Steel, Zn plated

Packing information

Poles	Order Number	SPQ
2	CAMBFW76202x000	150
3	CAMBFW76203x000	110
4	CAMBFW76204x000	80
5	CAMBFW76205x000	70
6	CAMBFW76206x000	55
7	CAMBFW76207x000	50
8	CAMBFW76208x000	40
9	CAMBFW76209x000	35
10	CAMBFW76210x000	35
11	CAMBFW76211x000	35
12	CAMBFW76212x000	25
13	CAMBFW76213x000	25
14	CAMBFW76214x000	25
15	CAMBFW76215x000	15
16	CAMBFW76216x000	15

Ordering code

CAMB FW 762 xx x xxx

① ② ③ ④ ⑤ ⑥

- ① Type
- ② Product style
- ③ Pitch
- ④ Poles (02-24)
- ⑤ Color
- ⑥ Standard 000 or Custom XXX

Color

0 Black	5 Green
1 Brown	6 Blue
2 Red	G Pale grey
3 Orange	8 Dark grey
4 Yellow	9 White

Key Commercial data

Custom tariff number	8536901000
Country of origin	CN (China)

Mating with headers

CAHACH762 Series



CAHACV762 Series

