

CAZCAB952-SERIES

cULus E501953

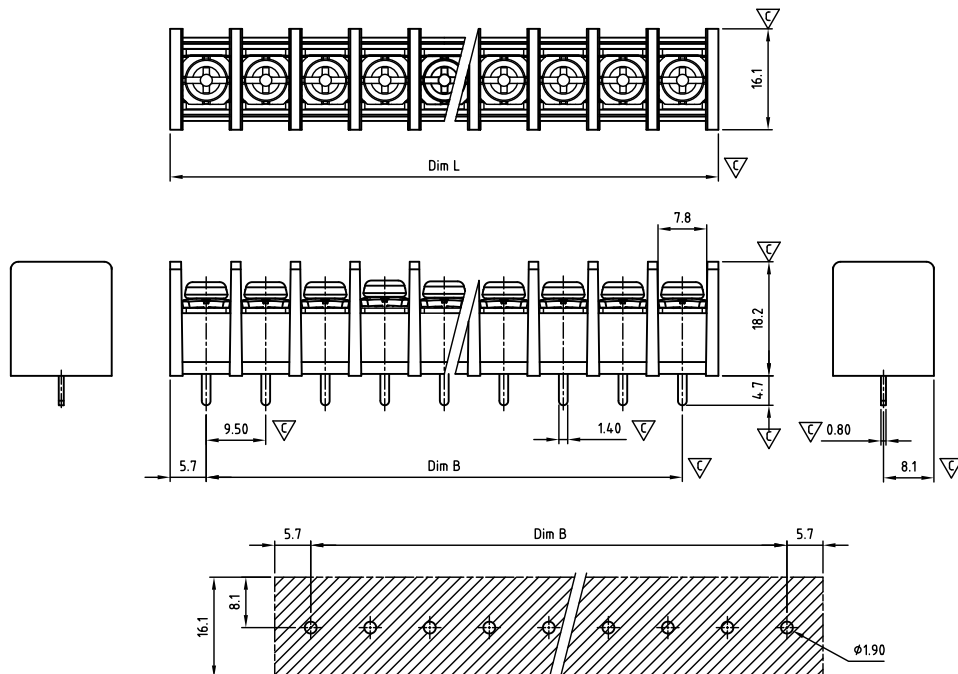

Critical dimension: ▽

Dim L=(P-1)×9.50+11.6

Dim B=(P-1)×9.50

P=Number of poles (02-24)

	Dim B	Dim L
0-30mm	+/- 0,15	+/- 0,20
over 30-60mm	+/- 0,20	+/- 0,25
over 60-90mm	+/- 0,25	+/- 0,30
over 90mm	+/- 0,30	+/- 0,40

Tolerance	
x.	+/- 0,50
x.x	+/- 0,30
x.xx	+/- 0,10
x°	+/- 1°

Units:mm

Technical data

Technical data in accordance with UL/CUL

	Use Group	B	C	D
Nominal voltage (V)		300	-	300
Nominal current (A)		30	-	10
Connection capacity(AWG)		22-10	-	22-10

Technical data in accordance with IEC

Rated insulation voltage at pollution degree 2 (V)	
Rated current/conductor cross-section (A/mm ²)	
Solid/stranded(mm ²)	
Surge voltage category/pollution degree	
Rated insulation voltage(V)	
Rated surge voltage(kV)	

General data

Stripping length(mm)	6-7
Screw thread	M3
Tightening torque(lb-in)	8.8
Insulation Withstanding Voltage	AC 1600 / 1min
Insulation Resistance	1000MΩ or more at DC500V
Using temperature range	-40°C-115°C
Soldering temperature	250±5°C/5s

Materials

Insulation material group	PA 66 I UL94 -V0
Contact	Brass, Tin plated
Screw	Steel, Zn plated

Packing information

Poles	Order Number	SPQ
2	CAZCAB95202x000	150
3	CAZCAB95203x000	108
4	CAZCAB95204x000	90
5	CAZCAB95205x000	72
6	CAZCAB95206x000	54
7	CAZCAB95207x000	35
8	CAZCAB95208x000	35
9	CAZCAB95209x000	35
10	CAZCAB95210x000	35
11	CAZCAB95211x000	30
12	CAZCAB95212x000	30
13	CAZCAB95213x000	15
14	CAZCAB95214x000	15
15	CAZCAB95215x000	15
16	CAZCAB95216x000	15
17	CAZCAB95217x000	15
18	CAZCAB95218x000	15
19	CAZCAB95219x000	15
20	CAZCAB95220x000	15
21	CAZCAB95221x000	10
22	CAZCAB95222x000	10
23	CAZCAB95223x000	10
24	CAZCAB95224x000	10

Ordering code

CAZC AB 952 xx x xxx

① ② ③ ④ ⑤ ⑥

- ① Type
- ② Product style
- ③ Pitch
- ④ Poles (02-24)
- ⑤ Color
- ⑥ Standard 000 or Custom XXX

Color

0 Black

Key Commercial data

Custom tariff number	8536901000
Country of origin	CN (China)



Pitch 9,50mm