

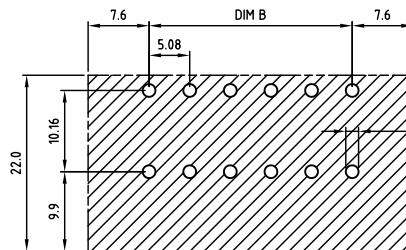

CAHAFH508-SERIES

Pitch 5,08mm

cULus E501953

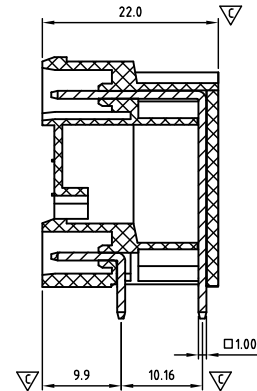
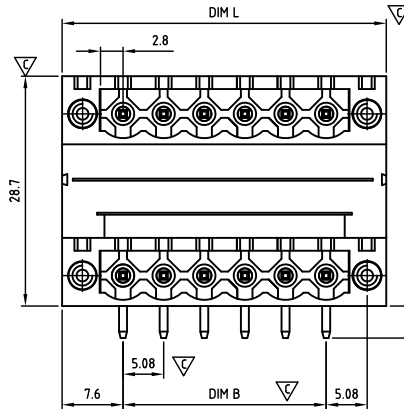
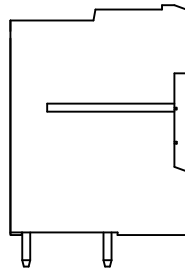

PCB LAYOUT

Critical dimension: ∇

Dim.L=(1/2P+2)x5.08

Dim.B=(1/2P-1)x5.08

P=Number of poles (04-48)

	Dim B	Dim L
0-30mm	+/- 0,15	+/- 0,20
over 30-60mm	+/- 0,20	+/- 0,25
over 60-90mm	+/- 0,25	+/- 0,30
over 90mm	+/- 0,30	+/- 0,40

2x2-2x12P ϕ 1.60
2x13-2x24P ϕ 1.70

Tolerance	
x.	+/- 0,50
x.x	+/- 0,30
x.xx	+/- 0,10
x°	+/-1°

Units:mm

Technical data

Technical data in accordance with UL/cUL

	Use Group	B	C	D
Nominal voltage (V)		300	-	300
Nominal current (A)		15	-	10
Connection capacity(AWG)		-	-	-

Technical data in accordance with IEC

Rated insulation voltage at pollution degree 2 (V)			320	
Rated current/conductor cross-section (A/mm ²)			12 / -	
Solid/stranded(mm ²)			-	
Surge voltage category/pollution degree	III / 3	III / 2	II / 2	
Rated insulation voltage(V)	250	320	400	
Rated surge voltage(kV)	4	4	4	

General data

Flange nut thread	M2.5
Flange nut tightening torque(Nm)	Max. 0.3
Insulation Withstanding Voltage	AC 1600 / 1min
Insulation Resistance	1000M Ω or more at DC500V
Using temperature range	-40°C-115°C
Soldering temperature	250 \pm 5°C/5s

Materials

Insulation material group	PA 66 I UL94 -V0
PIN	Copper, Tin plated
Flange nut	Brass
Borehole diameter/pin dimensions(mm)	1.6/1*1

Packing information

Poles	Order Number	SPQ
2*2	CAHAFH50804x000	72
2*3	CAHAFH50806x000	48
2*4	CAHAFH50808x000	48
2*5	CAHAFH50810x000	36
2*6	CAHAFH50812x000	36
2*7	CAHAFH50814x000	24
2*8	CAHAFH50816x000	24
2*9	CAHAFH50818x000	24
2*10	CAHAFH50820x000	24
2*11	CAHAFH50822x000	18
2*12	CAHAFH50824x000	16
2*13	CAHAFH50826x000	16
2*14	CAHAFH50828x000	16
2*15	CAHAFH50830x000	16
2*16	CAHAFH50832x000	12
2*17	CAHAFH50834x000	12
2*18	CAHAFH50836x000	12
2*19	CAHAFH50838x000	12
2*20	CAHAFH50840x000	12
2*21	CAHAFH50842x000	12
2*22	CAHAFH50844x000	6
2*23	CAHAFH50846x000	6
2*24	CAHAFH50848x000	6

Ordering code

CAHA FH 508 xx x xxx
① ② ③ ④ ⑤ ⑥

- ① Type
- ② Product style
- ③ Pitch
- ④ Poles (04-48)
- ⑤ Color
- ⑥ Standard 000 or Custom XXX

Color

0 Black	5 Green
1 Brown	6 Blue
2 Red	G Pale grey
3 Orange	8 Dark grey
4 Yellow	9 White

Key Commercial data

Custom tariff number	8536901000
Country of origin	CN (China)

Mating with headers

CAMAFT508 Series



CAMAFD508 Series



CAMBFR508 Series



CAMBFW508 Series



CAPAFD508 Series



CAPAFD508XXX100 Series

