

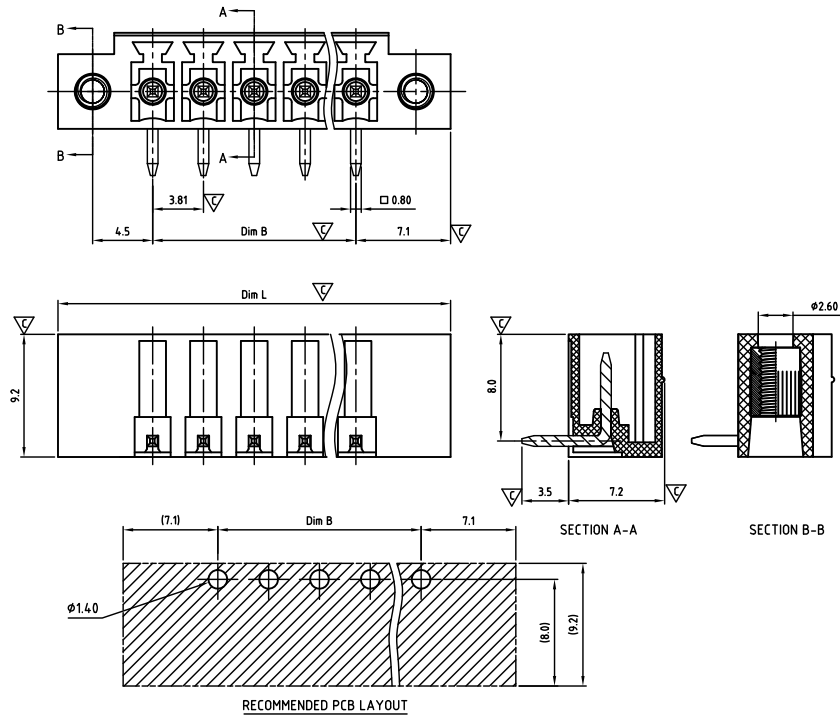

CAHACH381-SERIES

cULus E501953



Critical dimension: ∇

Dim L=(P-1)x3.81+14.2

Dim B=(P-1)x3.81

P=Number of poles (02-24)

| | Dim B | Dim L |
|--------------|----------|----------|
| 0-30mm | +/- 0,15 | +/- 0,20 |
| over 30-60mm | +/- 0,20 | +/- 0,25 |
| over 60-90mm | +/- 0,25 | +/- 0,30 |
| over 90mm | +/- 0,30 | +/- 0,40 |

| Tolerance | |
|-----------|----------|
| x. | +/- 0,50 |
| x.x | +/- 0,30 |
| x.xx | +/- 0,10 |
| x° | +/- 1° |

Units:mm

Technical data

Technical data in accordance with UL/cUL

| | Use Group | B | C | D |
|---------------------------|-----------|-----|---|-----|
| Nominal voltage (V) | | 300 | - | 300 |
| Nominal current (A) | | 8 | - | 8 |
| Connection capacity (AWG) | | - | - | - |

Technical data in accordance with IEC and VDE

| | | | |
|--|---------|---------|--------|
| Rated insulation voltage at pollution degree 2 (V) | 160 | | |
| Rated current/conductor cross-section (A/mm ²) | 8 / - | | |
| Solid/stranded(mm ²) | - | | |
| Surge voltage category/pollution degree | III / 3 | III / 2 | II / 2 |
| Rated insulation voltage(V) | 160 | 160 | 250 |
| Rated surge voltage(kV) | 2.5 | 2.5 | 2.5 |

General data

| | |
|----------------------------------|----------------------------------|
| Flange nut thread | M2.5 |
| Flange nut tightening torque(Nm) | Max. 0.3 |
| Insulation Withstanding Voltage | AC 1600 / 1min |
| Insulation Resistance | 1000M Ω or more at DC500V |
| Using temperature range | -40°C-115°C |
| Soldering temperature | 250 \pm 5°C/5s |

Materials

| | |
|--------------------------------------|--------------------|
| Insulation material group | PA 66 I UL94 -V0 |
| PIN | Copper, Tin plated |
| Flange nut | Brass |
| Borehole diameter/pin dimensions(mm) | 1.4/0.8*0.8 |

Packing information

| Poles | Order Number | SPQ |
|-------|-----------------|-----|
| 2 | CAHACH38102x000 | 700 |
| 3 | CAHACH38103x000 | 560 |
| 4 | CAHACH38104x000 | 400 |
| 5 | CAHACH38105x000 | 400 |
| 6 | CAHACH38106x000 | 400 |
| 7 | CAHACH38107x000 | 280 |
| 8 | CAHACH38108x000 | 240 |
| 9 | CAHACH38109x000 | 240 |
| 10 | CAHACH38110x000 | 240 |
| 11 | CAHACH38111x000 | 240 |
| 12 | CAHACH38112x000 | 220 |
| 13 | CAHACH38113x000 | 220 |
| 14 | CAHACH38114x000 | 190 |
| 15 | CAHACH38115x000 | 190 |
| 16 | CAHACH38116x000 | 165 |
| 17 | CAHACH38117x000 | 160 |
| 18 | CAHACH38118x000 | 160 |
| 19 | CAHACH38119x000 | 150 |
| 20 | CAHACH38120x000 | 150 |
| 21 | CAHACH38121x000 | 140 |
| 22 | CAHACH38122x000 | 140 |
| 23 | CAHACH38123x000 | 135 |
| 24 | CAHACH38124x000 | 135 |

Ordering code

CAHA CH 381 xx x xxx
① ② ③ ④ ⑤ ⑥

- ① Type
- ② Product style
- ③ Pitch
- ④ Poles (02-24)
- ⑤ Color
- ⑥ Standard 000 or Custom XXX

Color

| | |
|----------|-------------|
| 0 Black | 5 Green |
| 1 Brown | 6 Blue |
| 2 Red | 7 Pale grey |
| 3 Orange | 8 Dark grey |
| 4 Yellow | 9 White |

Key Commercial data

| | |
|----------------------|------------|
| Custom tariff number | 8536901000 |
| Country of origin | CN (China) |

Mating with headers

CAMAFT381 Series



CAMBFR381 Series



CAMBFW381 Series



CAPAF381 Series



CAPBFD381 Series

